

DIN Rail

Installing guide

The installing guide is designed according to the new Europe standard EN 50 022, EN 50 035, EN 50 045.

It has a precise height, strict tolerance, fine surface and good finish. The steel guide has been zinc-plated and yellow processed.

For the convenience of installing and making holes, there is a line printed on the center of guide which also exists on the aluminum and copper guide.

length and can be with round hole, long hole, or trough.

According to Part 3 of DIN VDE 0611, the installing guide can act as the general earth wire (PE function), but without function as neutral wire (PEN).

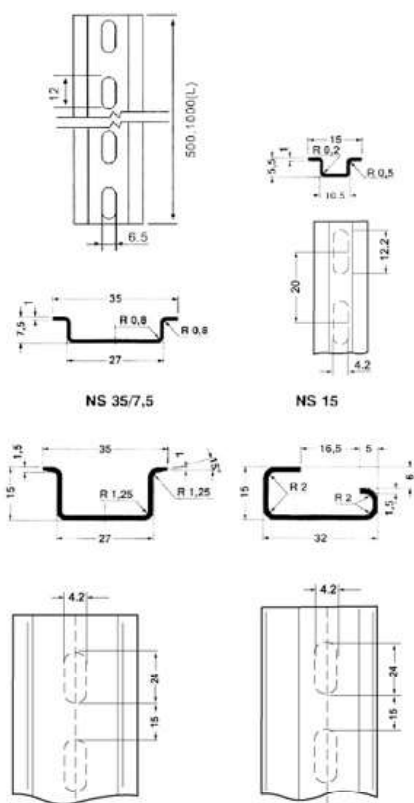

DIN Rail NS 15



Accessories

Model	Order number
According to EN 50 045-15×5mm Made of steel, yellow, Without hole length: 2m	
NS 15 Without hole	
Installing guide as above With hole	

DIN Rail NS 35/7.5



Accessories

Model	Order number
According to EN 50 022-35×7.5mm Made of steel, yellow, Without hole length: 2m	
NS 35/7.5 Without hole	
Installing guide as above With hole	

DIN Rail NS 35/15



Accessories

Model	Order number
According to EN 50 022 35×15mm Made of thick steel plate of 1.5mm High section, Without hole length: 2m	
Installing guide as above With hole, length 2m, NS 35/15 With hole	

DIN Rail NS 32



Accessories

Model	Order number
According to EN 50 035-G 32 Made of steel, Without hole length: 2m	
Installing guide as above With hole, length 2m, NS 32 With hole	

DIN rail retainer

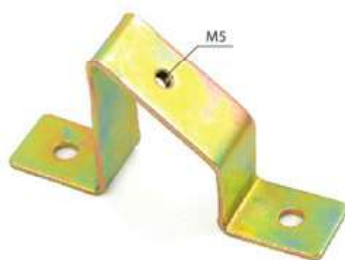

Model: TSTW

Thickness: 2mm

Aluminum DIN rail



NSL 35/7.5

NSL 35/15

NSL 30/15

Thickness: 1.5mm, 1.1mm

DIN rail cutting machine



NS1: Aluminum DIN rail NSL35/7.5 (1.1mm)
NS2: Aluminum rail NSL35/7.5 (1.5mm)
Steel rails NSL35/7.5 (1mm)

NS3: DIN rail NSL35/15 NS4: DIN rail NS32